

LED SPOT

IPLINE COB



IPLINE COB – RECESSED MOUNTED LED SPOT

This LEDSpot will give you the IP protection you are looking for with a clean design and a front panel protection made of glass.

Ready for damp locations

This highly IP protected LEDSpot will give you the best performance in every condition.

Typical applications

- Furniture lighting
- Residential lighting
- Retail lighting



IPLine COB

- **DEGREE OF PROTECTION: IP54**
- **NARROW COLOUR TOLERANCES: 3 SDCM**
- **HIGH-QUALITY COB TECHNOLOGY**
- **5 YEARS GUARANTEE**
- **MADE IN ITALY**



IPLine COB

Complete LEDspot IP54 equipped with optics, heat sink, leads and metal frame

Technical notes

- Metal frame, round
- For cut-out: \varnothing 56 mm
- LEDspot with one LED and with thermoplastic heat sink
- Reflector with clear glass
- Beam angle: 40°
- Colour accuracy initially: 3 SDCM
- CRI R_a : 80
- Leads: Cu tinned, stranded conductors AWG22, PVC-insulation, length: 250 mm
- Use of external LED constant-current drivers
- Snap-in clips for easy installation
- Degree of protection: IP54**
- Allowed ambient temperature: 0 to 40 °C
- Allowed storage temperature: -30 to 60 °C
- Lumen maintenance L70/B30: 50,000 hrs. ($t_c/t_p = 75$ °C)
- Max. operating temperature at t_c/t_p point: 85 °C
- Weight: 50 g
- Packaging unit: 45 pcs.

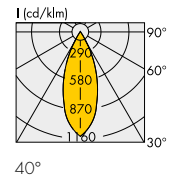
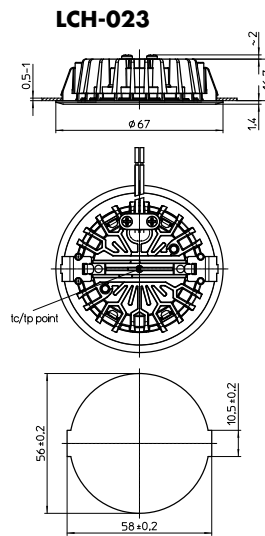
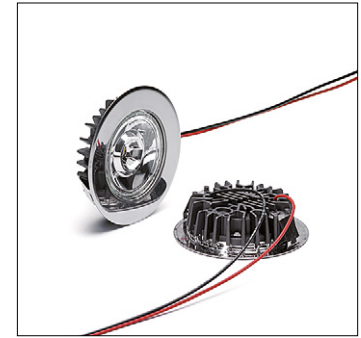

Type	Description	Ref. No.	Colour	Correlated colour temperature K	Luminous flux (lm) and typical voltage (U_{typ}) and power consumption (P_{el})*	Light intensity at max. current Candela	Beam angle °	Energy efficiency at max. current
		Frame colour silver white			350 mA min. typ.			
LEDspot IPLine COB (LCH-023)					$P_{el} = 3.15$ W; $U_{typ.} = 9$ V			
LCH-023	IPLine COB 3000K	564771 564770	warm white	3000	280 310	370	40	A++
LCH-023	IPLine COB 4000K	564773 564772	neutral white	4000	300 330	405	40	A++

Emission data at $t_l = 25$ °C | Further colour temperatures or frame colours on request
 * Production tolerance of luminous flux, voltage and power consumption: $\pm 5\%$

LED drivers

You will find more information about our LED drivers on our website: www.vossloh-schwabe.com

Capacity range W	Output current DC mA	Output voltage DC V	Ref. No.	Version	Current setting	Dimming	Max. service life time (hrs.)	Dimensions: mm (LxWxH)
350 mA								
7	350	8.4-20	186342	Easyline	—	—	50,000	81.6x42.5x23
9	350	2-25	186519	ComfortLine	—	—	100,000	65x30.7x21.5
11	350	2-32	186679	ComfortLine	—	—	100,000	128x37x28
12.6	350	8.4-36	186341	Easyline	—	—	50,000	122.8x45x19

Please ensure you choose the correct LED driver for the module in question and that the respective output parameters (current, voltage, wattage) are correct.

The values contained in this data sheet can change due to technical innovations. Any such changes will be made without separate notification.

IPLine – Installation Instruction

General safety information

- VS product may only be installed and commissioned by authorised and fully qualified staff.
- These instructions must be carefully read before installing and commissioning the system, as this is the only way to ensure safe and correct handling.
- An external driver for max. 350 mA is required.
- Before any work is carried out on the equipment, it must be disconnected from the mains.
- All valid safety and accident-prevention regulations must be observed.
- The products should never be inexpertly opened. Repairs may only be undertaken by the manufacturer.
- Dimming: The dimming characteristics of the installed driver have to be observed.
- The photo biological safety of the LED modules is classified into risk groups in accordance with EN 62471: 2008 and IEC TR 62778: risk group 1.

See drawing and cut out for each product on previous pages

Built-in

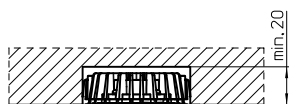

Correct position

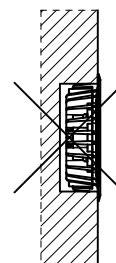
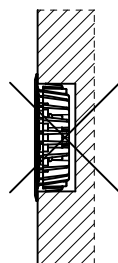
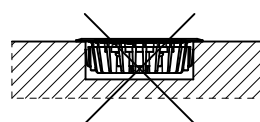

The values contained in this data sheet can change due to technical innovations. Any such changes will be made without separate notification.

All VS LED Spots at a glance

Tiny

LEDSpot with optics, leads and metal frame
 For cut-out: Ø 26 mm
 Beam angle: 36°
 Lumen output: max. 140 lm
 Versions: CC, CV, Kit



StartLine

LEDSpot with optics, heat sink, leads and frame
 For cut-out: Ø 56 mm
 Beam angle: 30°, 36°, 38°
 Lumen output: max. 250 lm
 Versions: CC, CV



EffectLine

LEDSpot with optics, heat sink, leads and metal frame
 For cut-out: Ø 37 mm
 Beam angle: 10°, 16°, 28° or 38°
 Lumen output: max. 250 lm
 Versions: CC

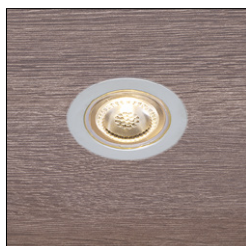

IPLine

LEDSpot IP54 with optics, heat sink, leads and metal frame
 For cut-out: Ø 56 mm
 Beam angle: 40°
 Lumen output: max. 330 lm
 Versions: CC



FlatLine

LEDSpot with optics, leads and metal frame
 For cut-out: Ø 56 mm
 Beam angle: 60°, 70°
 Lumen output: max. 270 lm
 Versions: CC, CV, TW, Kit



DisLine

LEDSpot with optics, heat sink, leads and metal frame
 For cut-out: Ø 56 mm
 Beam angle: 45°, 55°
 Lumen output: max. 220 lm
 Versionen CC



SmartLine COB

LEDSpot with optics, heat sink, leads and metal frame
 For cut-out: Ø 56 mm
 Beam angle: 40°
 Lumen output: max. 330 lm
 Versions: CC



SoftLine

LEDSpot with heat sink, leads and metal frame
 For cut-out: Ø 56 mm
 Beam angle: 90°
 Lumen output: max. 225 lm
 Versions: CV



SmartLine SMD

LEDSpot with optics, heat sink, leads and metal frame
 For cut-out: Ø 56 mm
 Beam angle: 36°, 40°
 Lumen output: max. 250 lm
 Versions: CC, CV



Revo

LEDSpot with optics and frame
 For cut-out: 67.5x25x5 mm
 Beam angle: 60°, 70°
 Lumen output: max. 255 lm
 Versions: CC, CV, TW

