

# BATWING OPTICS FOR LED PCBs

FOR WALL WASHERS AND FOR  
INDIRECT ILLUMINATION



## EXTRUSION OPTICS FOR LED PCBs W1.5

**For illumination with Wall Washers  
or for indirect illumination**



### Batwing Optics W1.5

- **SLIGHTLY OPAQUE PMMA EXTRUSION PROFILE**
- **OPTIMIZED FOR LED LINE SMD TYPES WU-M-499 AND WU-M-500 AND FOR LUGA LINE MODULES**
- **NO PIXELATION OF THE LIGHT BEAM**
- **TWO LENGTH AVAILABLE:  
560 MM AND 1,800 MM**

## Batwing Optics for LED PCBs W1.5

### Technical Notes

- Dimensions (LxVxH)  
Type 91000: 560/1800x24.7x31 mm  
Type 91010: 560/1800x24.7x25 mm
- Type 91000:  
for up- and down-lighting wall washers
- Type 91010:  
for indirect illumination
- Optimized for SMD PCBs of type WU-M-499/WU-M-500 and for LUGA Line modules

### Optical Characteristics

| Type  | Optical efficiency % |
|-------|----------------------|
| 91000 | 72                   |
| 91010 | 91                   |



### Maximum Ratings and Reference Numbers

Exceeding the maximum ratings can lead to reduction of service life or destruction of the optics.

| Type                             | Ref. No.      | Length mm | Operation temperature range |         | Storage temperature range |         |
|----------------------------------|---------------|-----------|-----------------------------|---------|---------------------------|---------|
|                                  |               |           | °C min.                     | °C max. | °C min.                   | °C max. |
| <b>For wall washer</b>           |               |           |                             |         |                           |         |
| 91000                            | <b>559587</b> | 1800 ±2   | -20                         | +70     | -20                       | +70     |
| 91000                            | <b>562895</b> | 560 ±2    | -20                         | +70     | -20                       | +70     |
| <b>For indirect illumination</b> |               |           |                             |         |                           |         |
| 91010                            | <b>559588</b> | 1800 ±2   | -20                         | +70     | -20                       | +70     |
| 91010                            | <b>562896</b> | 560 ±2    | -20                         | +70     | -20                       | +70     |

### Dimensions

#### 91000

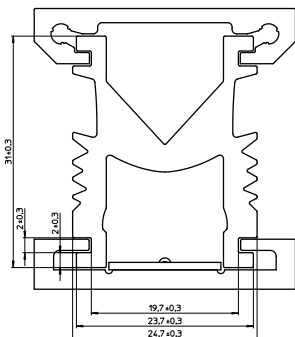

#### 91010

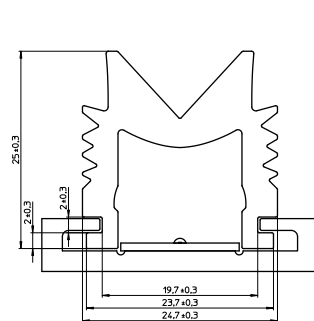

### Typical Light Distribution Curve

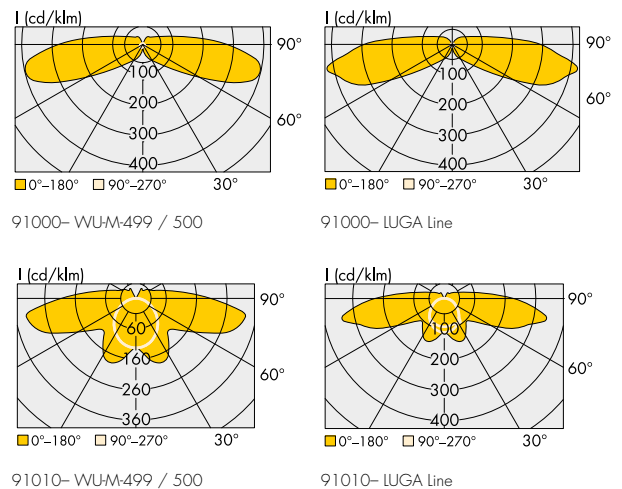

The values contained in this data sheet can change due to technical innovations. Any such changes will be made without separate notification.