

# LINEAR OPTICS 3R SMD W5.5

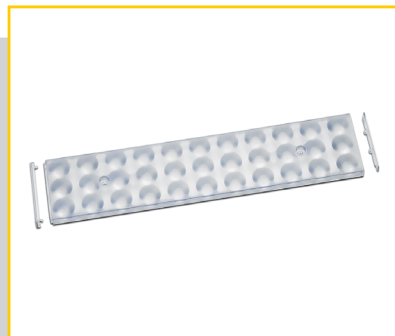

## LINEAR OPTICS 3R FOR SMD W5.5

The optics made of high-quality PMMA and PC offer a high degree of flexibility brilliant surfaces and light distributions a wide range of options for use in office, shop, aisle and shelf lighting (IP20 version) and for industrial and hall lighting (IP54 version).

The single lenses are suitable for 3030 and 2835 midpower LEDs from leading LED manufacturers. Typical LED types for use with this optics are Seoul STW8C2PB, STW8C12C, STW9C2PB (including Sunlike LEDs), Samsung LM301B, Nichia 757 (also available as Tuneable White).

For the creation of longer module chains, several optics can be strung together. Furthermore, matt optics with very low colour deviation via the light beam angle (CLC) and high-glossy optics with a low UGR value are available.

Matt surfaces produce a more homogeneous light and fewer multi-shadowing effects.

Spacers and end caps of various dimensions are available to realise luminaire louvre dimensions of 1,500 and 1,520 mm. They can be fastened with easy-to-install fastening clips or screws.



### Linear Optics 3R for SMD W5.5

- **EXCELLENT GLARE-FREE OPTICS DESIGN**
- **OPTICAL EFFICIENCY: UP TO 95%**
- **VARIANTS WITH UGR AND CLC OPTIMISED LIGHT DISTRIBUTION AVAILABLE**
- **UV-RESISTANT**
- **VARIANTS WITH IP54 (INCL. GASKET)**



Watch video

# Linear Optics 3R for SMD W5.5 33 Single Lenses 280mm IP20/40

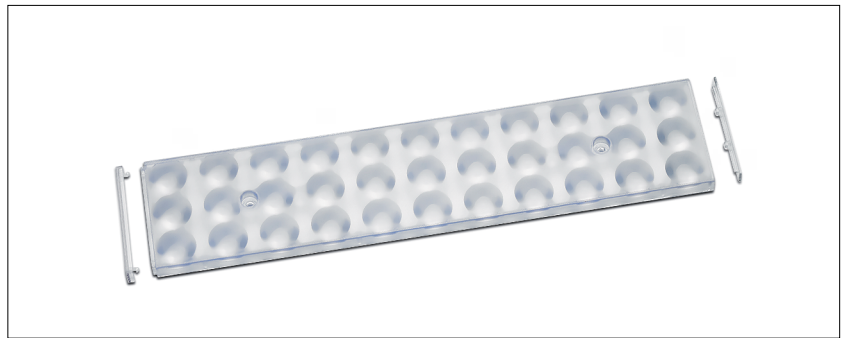

### Technical notes

- Material: PMMA, clear or diffuse
- Max. allowed temperature: 80 °C
- Dimensions (LxWxH): 285.4x62x11.25 mm
- Fixation with flat or cylinder head screws (M4) or with fixing clip
- Max. torque: 1.2 Nm (M4)
- End caps for luminaires degree of protection IP40



### Lighting properties

- CLC (constant light colour): very low colour temperature deviations over beam angle
- UGR: optimized glare reduction

Light distribution	Type	Ref. No.	Lighting properties	Material	Efficiency* %	Degree of protection	Weight g	Packaging unit pcs.
Extra Wide 110°	99400	<b>560371</b>	UGR	clear	95	IP20	105	120
	99410	<b>564557</b>	CLC	matt	95	IP20	105	120
Wide 80°	99415	<b>564559</b>	CLC	matt	95	IP20	80	120
Medium 60°	99401	<b>560372</b>	UGR	clear	95	IP20	88	120
	99411	<b>563660</b>	CLC	matt	95	IP20	88	120
Narrow 30°	99404	<b>560375</b>	UGR	clear	95	IP20	94	120
	99414	<b>564558</b>	CLC	matt	95	IP20	94	120
Retail SYM	99402	<b>560373</b>	UGR	clear	95	IP20	93	120
	99412	<b>563337</b>	CLC	matt	95	IP20	93	120
Retail ASYM	99403	<b>560374</b>	UGR	clear	95	IP20	99	120
	99413	<b>563338</b>	CLC	matt	95	IP20	99	120
Diffuse 105°	99400	<b>562543</b>	CLC	diffuse	85	IP20	105	120

\* Measured on a white luminaire sheet

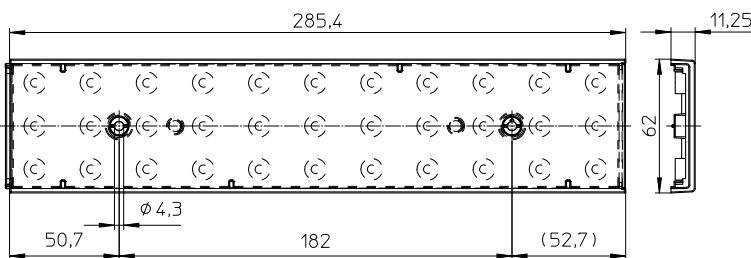

### Module Assembly

The L and D dimensions change with the number of modules and as a result of variations in the various end caps and spacers.

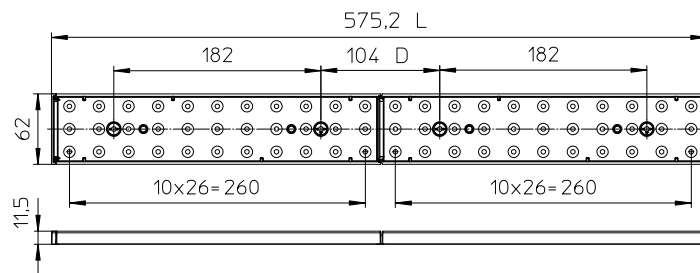

The values contained in this data sheet can change due to technical innovations. Any such changes will be made without separate notification.

## Linear Optics 3R for SMD W5.5 33 Single Lenses 280mm IP20/40

### Typ. light distributions with VS LED modules (with Seoul STW8C2PB)

At [www.vossloh-schwabe.com](http://www.vossloh-schwabe.com) you will find further light distribution curves with other LED types as well as all data in .ldt and .ies format for download.

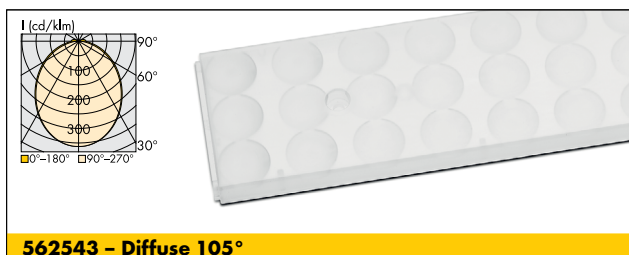
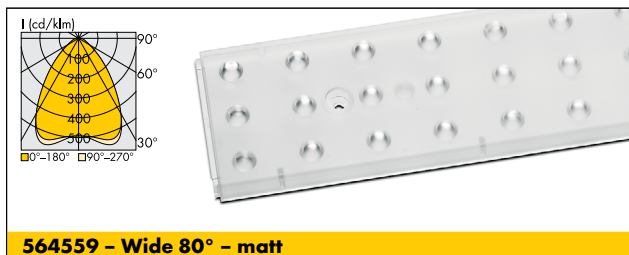

The values contained in this data sheet can change due to technical innovations. Any such changes will be made without separate notification.

## Linear Optics 3R for SMD W5.5 33 Single Lenses 280mm IP54



### Technical notes

- Incl. inserted, circumferential gasket tape for IP54 luminaires
- Optics material: PMMA, clear or diffuse or PC for higher impact ratings (IK07/2 Nm)
- PC variants: glow wire test 850 °C
- Max. allowed temperature: 80 °C for PMMA and 100 °C for PC
- Dimensions (LxWxH): 298x64x11.75 mm
- Fixation with flat or cylinder head screws (M4) to ensure optimum contact pressure for the gasket
- Max. torque: 1.2 Nm (M4)
- Optics also available without seal for IP40 applications on request



### Lighting properties

- CLC (constant light colour): very low colour temperature deviations over beam angle
- UGR: optimized glare reduction

Light distribution	Type	Ref. No.	Lighting properties	Material	Efficiency* %	Degree of protection	Weight g	Packaging unit pcs.
Extra Wide 110°	99503	<b>571762</b>	CLC	PMMA, clear	96	IP54	135	96
		<b>571764</b>	CLC	PC, clear	94	IP54	135	96
Wide 90°	99505	<b>564168</b>	UGR	PMMA, clear	97	IP54	120	96
		<b>570435</b>	UGR	PC, clear	95	IP54	120	96
Medium 60°	99501	<b>564166</b>	UGR	PMMA, clear	98	IP54	117	96
		<b>569346</b>	UGR	PC, clear	96	IP54	117	96
Narrow High Rack	99504	<b>564167</b>	UGR	PMMA, clear	96	IP54	120	96
		<b>572476</b>	UGR	PC, clear	94	IP54	120	96
Diffuse 100°	99501	<b>564461</b>	CLC	PMMA, diffuse	91	IP54	117	96

\* Measured on a white luminaire sheet

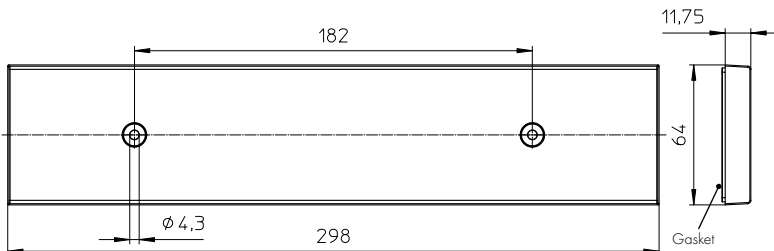

The values contained in this data sheet can change due to technical innovations. Any such changes will be made without separate notification.

## Linear Optics 3R for SMD W5.5 33 Single Lenses 280mm IP54

### Typ. light distributions with VS LED modules (with Seoul STW8C2PB)

At [www.vossloh-schwabe.com](http://www.vossloh-schwabe.com) you will find further light distribution curves with other LED types as well as all data in .ldt and .ies format for download.

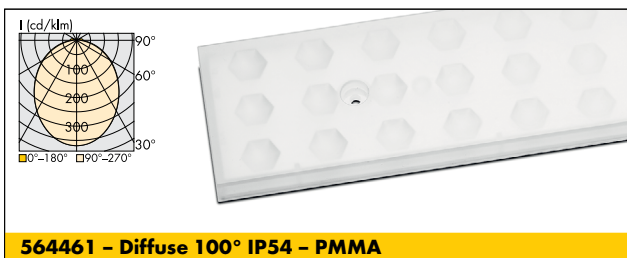

### Suitable VS LED modules

W5.5 optics are suitable for 3-row modules LED Line SMD Kit 3R.

VS LED modules	Module type	Connection terminals		W5.5 optics
		BC	TC	
LED Line SMD Kit 3R Gen. 3	WU-M-526-S, WU-M-536-S	BC	TC	All
LED Line SMD Kit 3R Gen. 4	WU-M-526-S2, WU-M-536-S2	BC	TC	All
LED Line SMD Kit 3R Hi-CRI	WU-M-526, WU-M-526-HB, WU-M-536, WU-M-536-HB	BC	TC	All
LED Line SMD Kit 3R CSP Tuneable	WU-M-567, WU-M-568	BC	TC	All

The values contained in this data sheet can change due to technical innovations. Any such changes will be made without separate notification.



## Accessories for Linear Optics 3R for SMD W5.5

### 33 Single Lenses 280mm IP20/40

#### End caps for W5.5 optics type 994

Lateral attachment on the optics (on the side of the groove or tongue)  
Material: PC, clear

End cap type	For optics type	Ref. No.	Length L mm	Weight g	Packaging unit (pcs.)
Tongue side	994	<b>560377</b>	3.8	1.6	250
Tongue side	994	<b>560785</b>	7	2.3	250
Groove side	994	<b>560378</b>	—	1	500
Groove side	994	<b>560786</b>	7	3.3	500



End caps

#### Spacer for W5.5 optics type 994

For creating different lengths of lighting strips  
Insert in optics to connect (groove or tongue side)  
Material: PMMA, clear or diffuse

Spacer type	For optics type	Ref. No.	Material	Length L mm	Weight g	Packaging unit (pcs.)
Short	994	<b>564458</b>	clear	13.9	4.5	350
Short	994	<b>564459</b>	diffuse	13.9	4.5	350
Short, VS brand	994	<b>560793</b>	clear	13.9	4.5	350
Short, VS brand	994	<b>564678</b>	diffuse	13.9	4.5	350
Long	994	<b>563187</b>	clear	21.4	6.1	350
Long	994	<b>564457</b>	diffuse	21.4	6.1	350
Long, VS brand	994	<b>560789</b>	clear	21.4	6.1	350
Long, VS brand	994	<b>564677</b>	diffuse	21.4	6.1	350



Spacers, clear



Spacers, matt

#### Fixing clips for W5.5 optics type 994

For screwless fastening of optics together with the LED PCB  
(max. PCB thickness: 1.6 mm) to the luminaire sheet  
Vibration resistant version  
Material: PA, natural (UL-94 V-2)

Type	Ref. No.	For luminaire sheet thickness* (MS) mm	Length L mm	Weight g	Packaging unit (pcs.)
98001	<b>562557</b>	0.5–1.2	8	0.2	1000
98002	<b>562558</b>	1.3–2.1	9	0.2	1000
98003	<b>562559</b>	2.2–3.0	10	0.2	1000

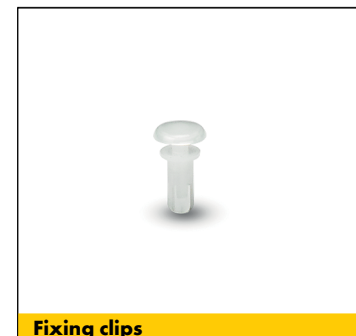

Fixing clips

#### End caps

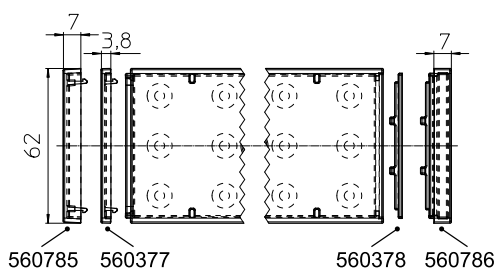

#### Spacers

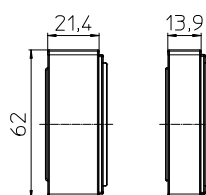

#### Fixing clips

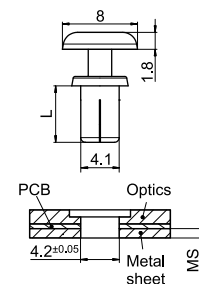

The values contained in this data sheet can change due to technical innovations. Any such changes will be made without separate notification.