

# LED High Bay

VS-L0115-xxx

220-240V AC, 50-60Hz

Installation Manual

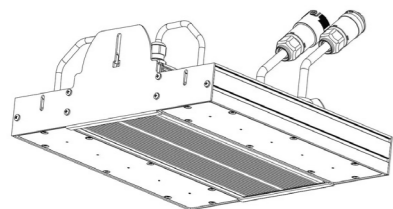

**VS LIGHTING SOLUTIONS**

Vossloh-Schwabe Deutschland GmbH  
Hohe Steinert 8, D-58509 Lüdenscheid  
www.vossloh-schwabe.com

## Dimension

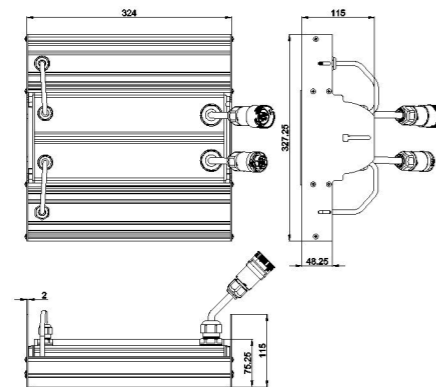

## Connector

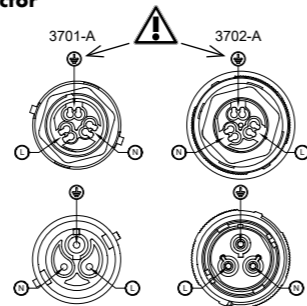

## Connector - DALI

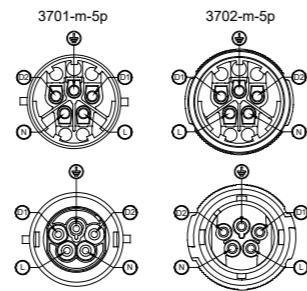

## Cable Stripping

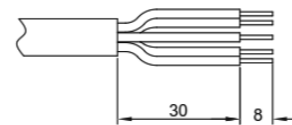

Cable: 2.5mm<sup>2</sup>

## Cable Connection

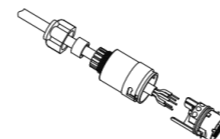

## Plug Connection

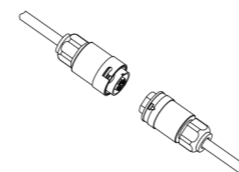

## Suspension (Not included)

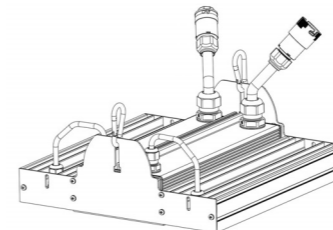

## Ceiling Mounting Type

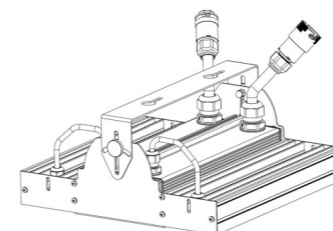

## Wiring

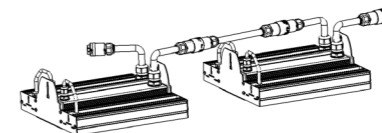

Selection of automatic cut-outs for VS LED drivers

Type	Automatic cut-out type and possible no. of VS drivers pcs.					
Automatic cut-out type	B10 A	B13 A	B16 A	C10 A	C13 A	C16 A
VS-L0115-xxx-70W	8	11	14	14	19	23
VS-L0115-xxx-100W	5	7	9	9	12	15
VS-L0115-xxx-100W-DA	9	11	14	15	19	24

## General Instructions

- EN** This includes the general mounting instructions. Subject to technical alterations!
- D** Hierzu gehören die allgemeinen Montagehinweise. Technische Änderungen vorbehalten!
- F** Les instructions de montage générales font partie de ces instructions. Sous réserve de modification technique!
- E** Esto incluye los avisos generales de montaje. Nos reservamos el derecho de realizar modificaciones técnicas!
- I** Queste comprendono le istruzioni generali per il montaggio. Il prodotto potrebbe subire modifiche tecniche!
- NL** Hiertoe behoren de algemene montage-instructies. Technische veranderingen!
- PL** Należą do tego ogólne wytyczne montażowe. Zmiany techniczne zastrzeżone!



T<sub>a</sub> - 20° C to 40° C



RoHS

